



35mm wide
Rail Mount

Certifications:   
PENDING

Features:

- Leakage current monitoring in 1Ø and 3Ø systems
- RMS value measurement
- CBCT detection
- User selectable Power ON delay, response delay and delay on release
- Adjustable hysteresis
- Two separate alarm relays with NO or NC operation selectable
- Test and Reset via front / remote

Technical Specifications

Display

Display	Liquid Crystal Display with backlight
Digits	3

Input Specifications

Functions	
Measurements	Leakage current monitoring (via external CBCT)
Time Settings	Power ON delay, response delay, delay on release
Alarm Indications	Pre - warning alarm, Trip, CBCT error
Latching	Selectable
Reset	Auto / Manual
Electrical Connection	1Ø-2 wire, 3Ø-4 wire
Auxiliary Supply	
Supply Voltage	a) 110V AC, ±15% b) 230V AC, ±15% (factory set) c) 10V - 28V DC
Frequency	45 - 65Hz
VA Rating	3VA max
Trip Settings	
Leakage Current	10mA - 30A
Pre Alarm	50 - 90% of leakage current setting
CBCT Detection	Every 3sec when leakage current < 5mA
Trip Time Settings	
Power ON Delay	0.5 - 99.9sec
Response Delay (Trip time delay)	0 - 99.9sec
Delay ON Release	0 - 99.9sec
Response Time	< 50ms (if trip current = 5 x set value) < 100ms (if trip current = 1 x set value)
Hysteresis	
Current	0.5mA – 9.9A (Depends on trip setting)
Resolution	
Current	0.1, 1mA, 0.01A, 0.1A (Depends on trip setting)
Accuracy	
Current	±5% of Setting
Time (Recovery Time, Trip Delay, Power ON Delay)	±5% of setting + 100ms

Output Specifications

No. of Relays	2
Type of output (Relay1)	1C/O (SPDT)
Type of output (Relay2)	1C/O (SPDT)
Relay Rating	NO : 5A, 250V AC NC : 3A, 250V AC

LED Indication

LED1 (Red)	Alarm (Continuously ON after trip)
LED2 (Red)	Pre - Alarm (Continuously ON during pre alarm condition)

Note - LED1 and LED2 blink during CBCT error

Environmental Specifications

Temperature	Operating Temperature: 0°C to +55°C Storage Temperature : -20°C to +75°C
Humidity (non-condensing)	Upto 95% RH
Installation	Indoors
Altitude	Upto 2000m
Pollution Degree	2

Mechanical Specifications

No. of Push Buttons	3
Size	35mm width
Mounting	Din Rail Mount
Wire Size (max)	4 sq.mm
Screw tightening torque	0.5 N-M

Dimensions

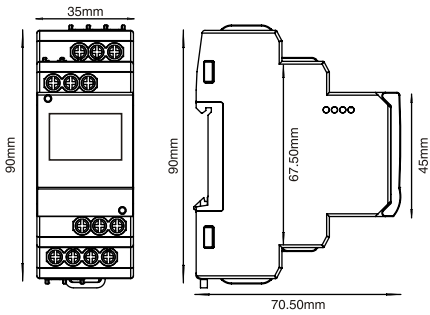

Terminal Connections

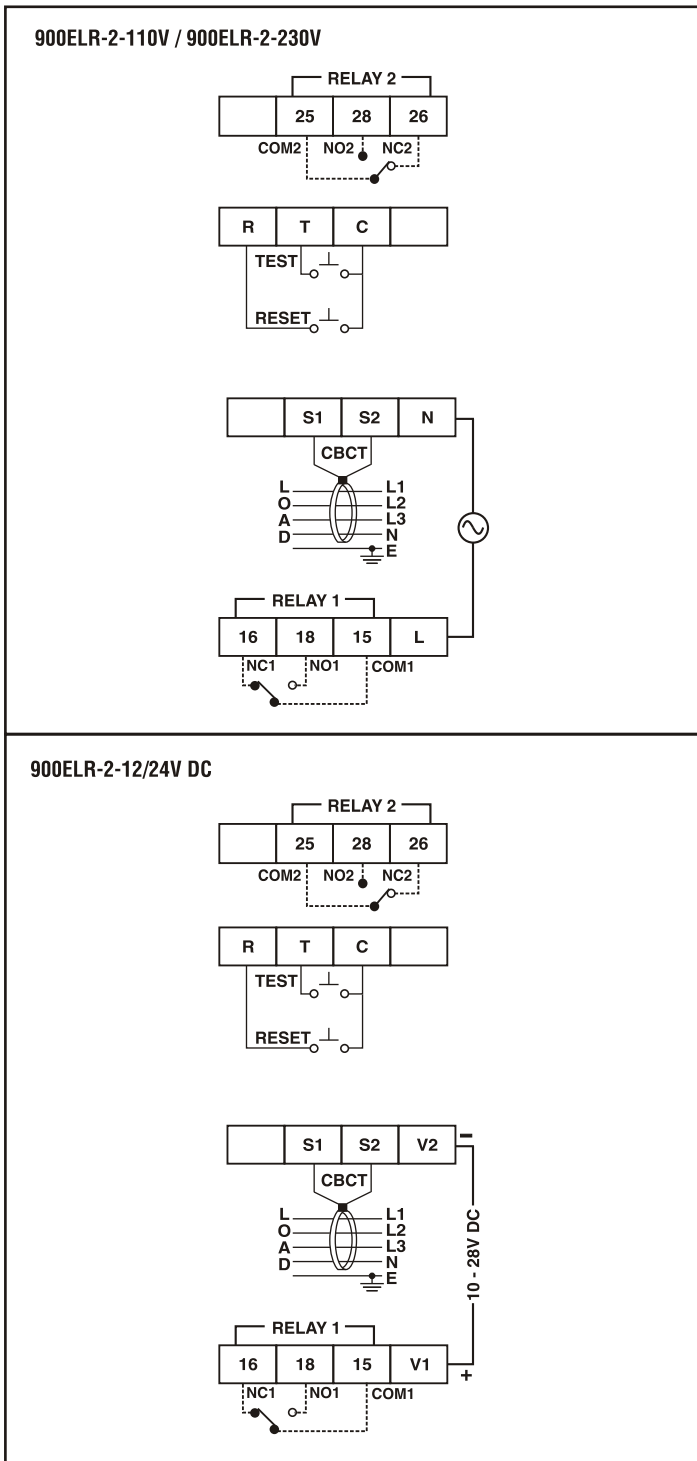

Ordering Information

Part No.	Supply Voltage
900ELR-2-110V	110V AC, ±15%
900ELR-2-230V	230V AC, ±15%
900ELR-2-12/24V DC	10 - 28V DC

Accessories

CBCT



Technical Specifications

Input Specifications

Current Transformer Type	Closed Toroid
Turns Ratio	1000 : 1
Rated Current	30A

Dimensions

Model	Dimensions (mm)				
	D	d	H	W	W1
CBCT-35-1	64	45	96	13	52.5
CBCT-70-1	98	82	131	13	87
CBCT-120-1	149	125	184	13	122
STD. TOL.	2 - 3	5 - 6	-	1.5 - 2	-

CT Type ZPC (Zero Phase Current)

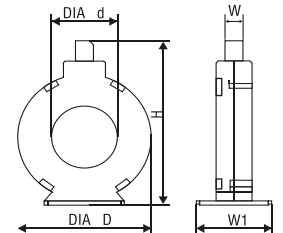

Ordering Information

Part No.	Inner Diameter	Turns Ratio
CBCT - 35-1	35mm	1000:1
CBCT - 70-1	70mm	1000:1
CBCT - 120-1	120mm	1000:1